

## **PS-3315/3315E/3316/3316E Fanless LCD Touch Terminal User Manual**



### **Package Contents**

- ✓ PS-3315/3315E/3316/3316E fanless LCD touch terminal (x 1)
- ✓ 12V/40W Power adaptor (x 1)
- ✓ Power cord (x 1)
- ✓ User Manual (x 1)

### **Product Features**

- Fanless terminal
- Foldable base that allows PS Series to be configured into different configurations
- 5-wire resistive touch for PS-3315/3315E/3316/3316E
- Integrated structure for side mount upgrade kit: SA-105/205/305/405/505; back mount display: LM-6807U / 6810U and PD-360R/360UE/2609UE/6807U; 40-key dynakey attachment with MSR or RFID option: KP-500
- Water resistant structure designed for easy cleaning

## Views of PS-3315/3315E/3316/3316E

### Front View

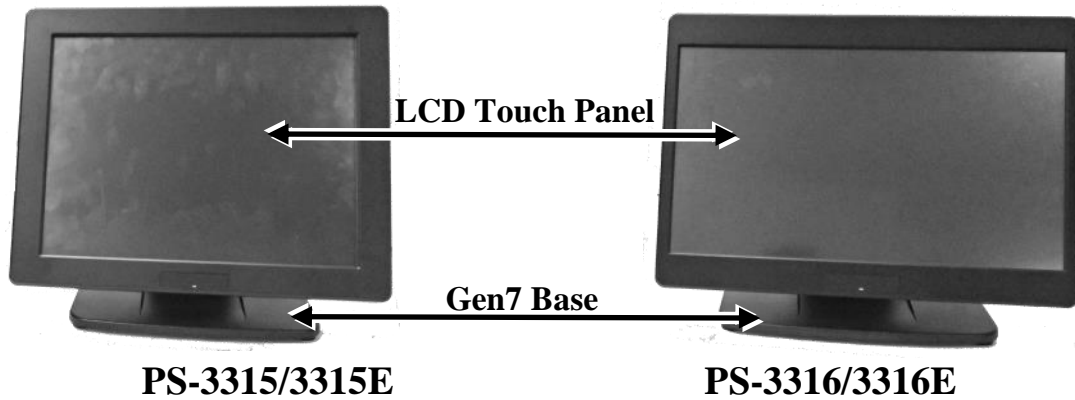

### Rear View

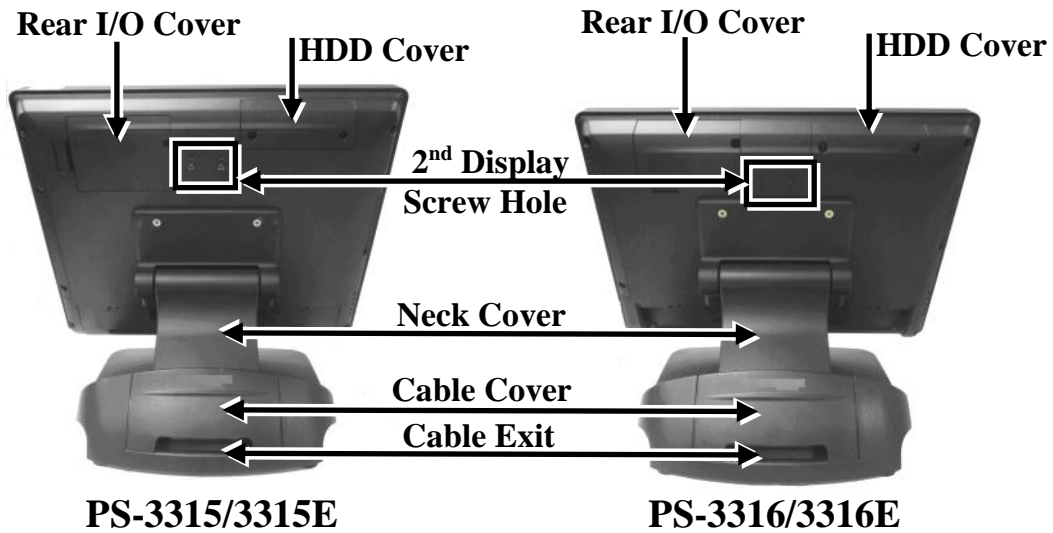

### Left Side View



## Right Side View

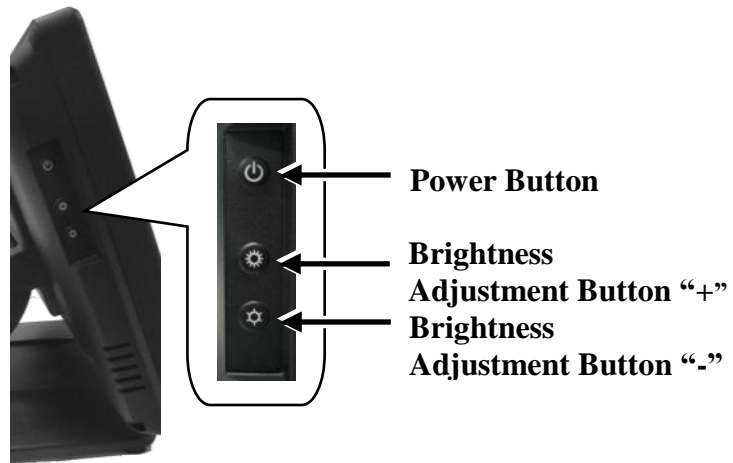

## Bottom View

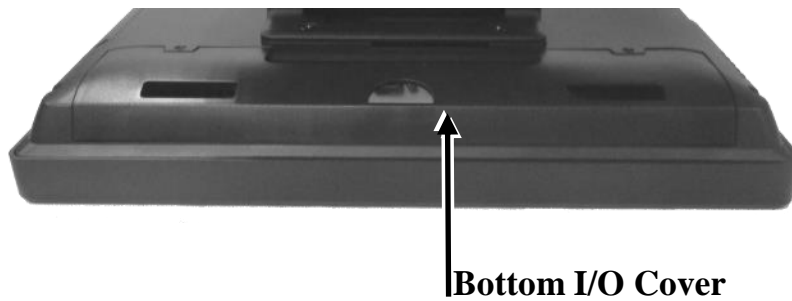

## **View of I/O Interface**

### Top I/O Ports



1 2

- 1 COM4 Port
- 2 USB 2.0 Port

### Rear I/O Ports

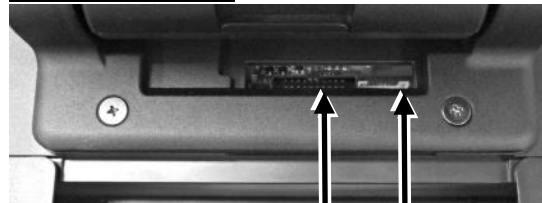

3 4

- 3 Parallel (LPT) Port Connector
- 4 PS/2\_KB Pin Header

## Bottom I/O Ports

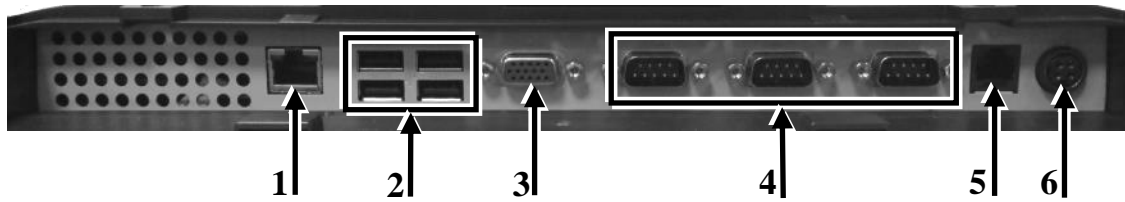

- |                         |                                |
|-------------------------|--------------------------------|
| 1 RJ45 LAN Port         | 2 USB 2.0 Port                 |
| 3 VGA Port              | 4 COM Port<br>(COM3/COM2/COM1) |
| 5 RJ11 Cash Drawer Port | 6 12VDC-IN Power Jack          |

## **Positioning your POS for a Perfect Viewing Angle**

The adjustable Gen7 base is designed to help you determine an ideal position for PS-3315/3315E/3316/3316E using its unique tilt adjustment mechanism. As the below figures suggest, Gen7 base basically provides three standard positioning solutions for your terminal: **Flat Folded mode**, **Low Profile mode**, and **Full Extended mode**.

### **PS-3315/3315E/3316/3316E with Gen7 Base**



**Flat Folded mode**

**Low Profile mode**

**Full Extended mode**

In general, PS-3315/3315E/3316/3316E will be set up beforehand in **Flat Folded** mode and then packaged into the box for shipping. After it is unpacked, you may re-adjust the terminal in either **Low Profile mode** or **Full Extended mode** according to your situation. Below will provide instructions on how to adjust the specific base connected to the POS system. As a reminder, please be careful not to touch the LCD panel while setting up the tilt angle. Please refer to the following instructions on how to switch among different positioning modes to find an ideal viewing angle for PS-3315/3315E/3316/3316E with Gen7 base.

1. Unpack PS-3315/3315E/3316/3316E, which is supposed to be set in **Flat Folded mode**, out of the package box and then lay your POS system on a flat surface.



2. Steady the base with one hand, and then tilt the screen downwards.



3. Position your terminal in **Full Extended mode**

- 3.1 After grabbing the bottom edge of the screen with your hand, gently move the screen upward until the screen is locked into place with a click sound.

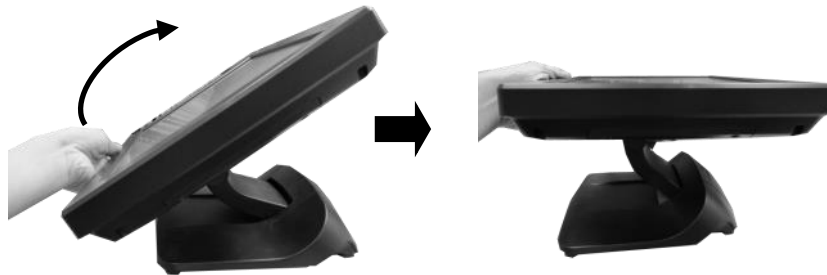

- 3.2 With the screen facing toward you, tilt the screen up or down to your desired angle. Please do not press on the LCD panel while setting up the tilt angle.



4. Return your terminal back to **Flat Folded mode** from **Full Extended mode**.

4.1 Tilt your screen in a horizontal position. Then, remove the cable cover from the base.

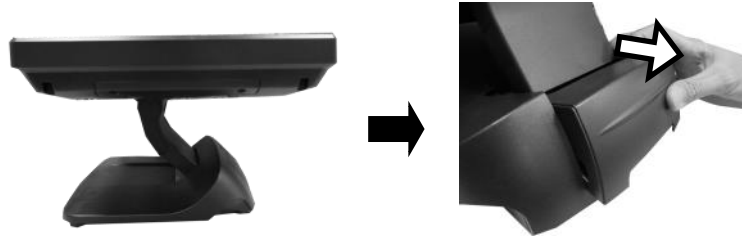

4.2 Support the screen with one hand holding onto its bottom edge. While pulling the lever backwards, move the display downwards until the lever is lifted off the hook as shown in the figure

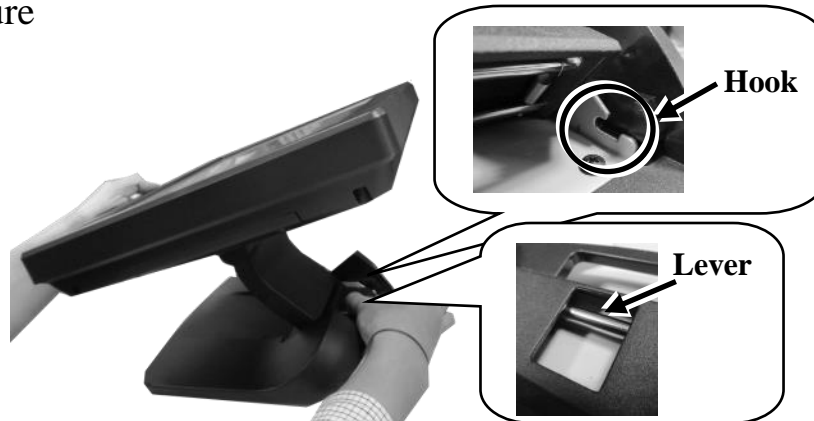

4.3 Push the cable cover back.



4.4 Tilt the screen again to the horizontal position.



## 5. Position the terminal in **Low Profile mode**.

5.1 Follow Step 4 to set up the terminal in **Flat Folded mode**.



5.2 Tilt the screen all the way down



5.3 To tilt screen up or down to your desired angle, please be advised to keep the base steady with one hand to do so. Do NOT press on the LCD panel while setting up the tilt angle.



## **Installing Optional Upgrade Kits and Peripherals**

PS-3315/3315E/3316/3316E can work with multiple optional upgrade kits and peripheral devices, such as magnetic stripe reader (MSR), LCD monitor, cash drawer and the like. Before installing an optional upgrade kit and/or peripheral device, make sure that the system is powered off and the external power source is removed from the POS box to prevent electric hazard. For the detailed instruction, refer to each of the user manuals of the optional upgrade kits and peripheral devices.

## Connecting Power Adapter and I/O Cables

Gen7 base features its own cable management to assist you in well organizing the cords whenever you need to connect peripheral devices to PS-3315/3315E/3316/3316E. The following provides some useful cable-routing instructions required to manage your cables.

1. Set up your terminal in **Full Extended mode** and then tilt the screen all the way down.



2. Remove the cable cover from the base.

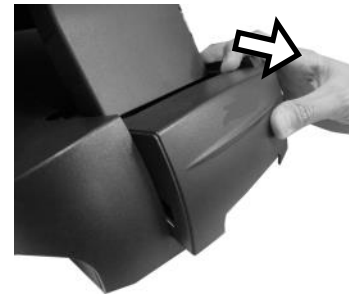

3. Pull outwards the locking levers with your forefingers and then remove the neck cover in the direction shown by the arrow.



4. Tilt the terminal to the horizontal position. Then, thread cables through the cable passage.

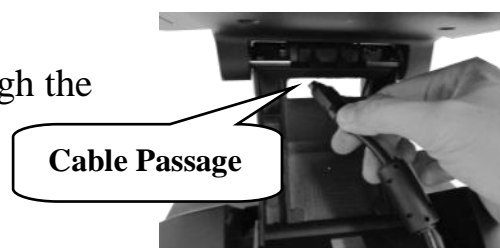

5. After tilting the screen all the way up, remove the bottom I/O cover to locate the bottom I/O plate.





6. Connect the connector of the power adapter to the 12VDC-IN power jack.



7. Tuck the extra cables inside the bottom I/O compartment, and then push back the cover to close it.

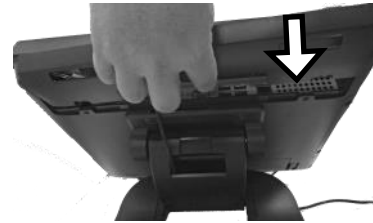

8. Tilt the screen all the way down.



9. After neatly arranging the cable, place back the neck cover.

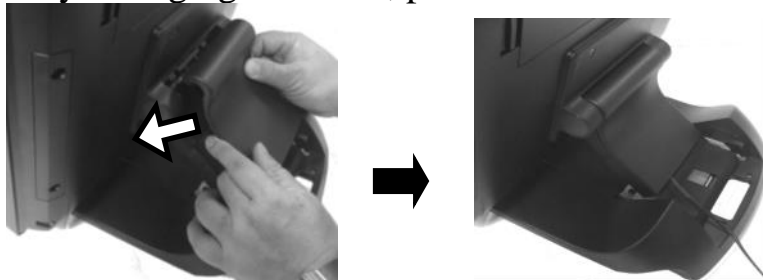

10. Push back the cable cover. Please also make sure that cables can be routed through the cable exit.

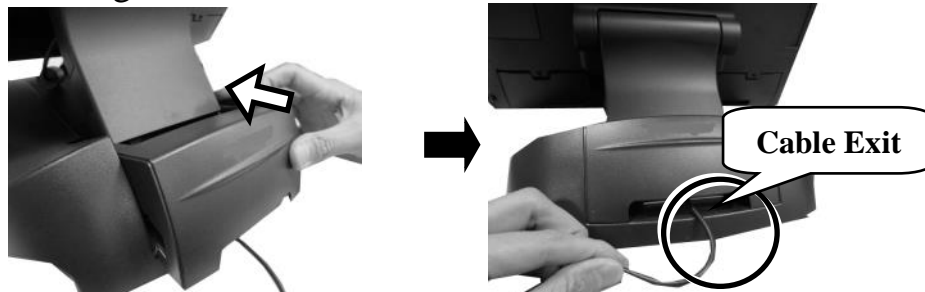

## Powering ON the PS-3315/3315E/3316/3316E

### Power ON PS-3315/3315E/3316/3316E

Press down the power button for at least 3 seconds to power on the POS.

### Power OFF PS-3315/3315E/3316/3316E

In most cases, press the power button of the POS to power the system off. If the terminal fails to turn off the machine for unknown reasons, please be advised to hold the power button more than 10 seconds to force a shutdown of the system.

Once powering off the system, if you want to power it on again, please wait at least 3 seconds.



## Power LED Indicator

Power LED indicator, which is located at the center of the bottom edge of the LCD panel, is mainly responsible for notifying users of the current system status by emitting various LED signals. The chart provided below will offer helpful information that you need to interpret LED status.



LED	Status	Description
POWER	Solid blue	System power ON
	Solid orange	System standby

### **Installing an Operating System**

You are highly advised not to install an operating system on PS-3315/3315E/3316/3316E without professional instructions. Not only might the careless handling during installation cause irreversible damage to your machine, but also the improper installation likely leads to system malfunction or failure. Please contact with your dealers about the issues of operating system installation.

### **Operating System Recovery**

For PS-3315/3315E/3316/3316E models with preloaded operating systems, you are not encouraged to recover your system without the help of system integrators. Please be advised to contact your service center for further assistance with system recovery.

### **Operation Environment**

To prevent PS-3315/3315E/3316/3316E from overheating, it is suggested to position your terminal in a well-ventilated working environment. In doing so, please be advised to keep the POS terminal at least 25mm away from other devices to ensure the machine is properly cooled down and functioning normally.

## Specifications

	PS-3315/3316	PS-3315E/3316E
Processor	Intel Bay Trail-M, N2807	Intel Bay Trail-D, J1900
System Memory	2GB DDR3L 1333MHz default	
Storage Device	SATA x 1	SATA x 1 (supporting SSD only)
Power Supply	12V/40W (upgrades to 60W or higher when required)	
OS support	Windows 7 / POSReady 7 / Windows Embedded 8.1 Industry / DOS/ Linux per request	
LCD Panel	15" 1024 x 768 TFT LCD for PS-3315/3315E 15.6" 1366 x 768 TFT LCD for PS-3316/3316E	
Touch sensor	5-wire resistive touch with front bezel	
Touch Controller	USB interface	
Serial Port	4 ports, 3 x DB9 on bottom I/O plate + 1 x RJ50 on top I/O plate, 5V/12V support on all COM ports	
Parallel Port	1 port, via optional conversion cable	
Standard USB Port	5 external ports (4 on bottom I/O plate + 1 on top I/O plate) + 3 internal ports	
LAN Port	10 / 100 / 1000 Mb x 1	
Display Port	VGA x 1, 12V support for Posiflex monitors	
CR Port	1 port, controlling 2 CR via optional Y-cable	
PS/2 Port	Pin header inside service window	
Audio	Buzzer only	
WiFi	USB WiFi dongle	
Base Stand	GEN7 foldable base	
Environmental Requirements	Operating : 0°C - 40°C, 20%RH - 90%RH (Equipped with HDD); 0°C - 50°C, 20%RH - 90%RH (Equipped with SSD) Storage : -20°C - 70°C, 10%RH - 90%RH	